

## Inclined Stainless Steel-Cabinet U-handles

### SPECIFICATION

#### Type

- Type **A**: Mounting from the back (threaded blind bore)

Stainless Steel

- AISI 304

- matt shot-blasted **MT**



### INFORMATION

Inclined Stainless Steel-Cabinet U-handles GN 565.7 are produced from profiled Stainless Steel extrusions. Their special features are their rigidity and ergonomic shaping.

The angled contact surface allows improved access even in tight spaces such as corners.

The manufacturing process (bending) allows the production of **special lengths** in relatively small quantities.

### TECHNICAL INFORMATION

- Stainless Steel characteristics (see page A26)

- Load rating information (see page A35)

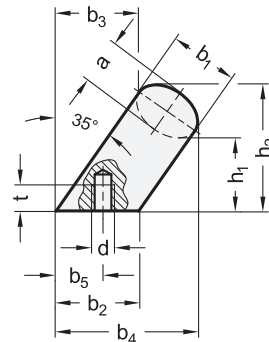
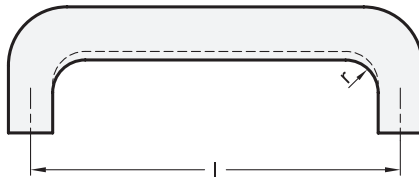

Application example

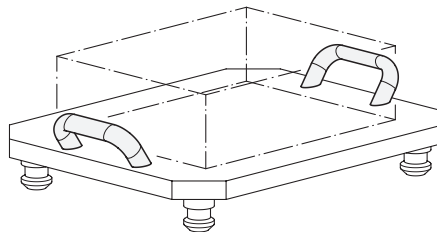

### GN 565.7

### STAINLESS STEEL

Description	b1	l ±0.25	a	b2	b3	b4	b5 +1	d	h1	h2	r	t min.	⚖
GN 565.7-20-112-A-MT	20	112	13	24	32	50	13.5	M6	32	48	13	10	308
GN 565.7-20-128-A-MT	20	128	13	24	32	50	13.5	M6	32	48	13	10	340
GN 565.7-26-128-A-MT	26	128	17	32	34	57	18	M8	34	54	17	12	569
GN 565.7-26-160-A-MT	26	160	17	32	34	57	18	M8	34	54	17	12	657

